

## Bevel Gear Wheels

with Spiral Bevel for Linear Actuators /  
Transfer Units with Angular Gear

### SPECIFICATION

#### Types

- Type **R**: Bevel gear wheel, right-hand pitch
- Type **L**: Bevel gear wheel, left-hand pitch
- Type **W**: Set of bevel gears, 2 bevel gears, 1 x right-hand pitch,  
1 x left-hand pitch
- Type **T**: Set of bevel gears, 3 bevel gears, 1 x right-hand pitch,  
2 x left-hand pitch

Steel  
Hardened  
Teeth milled



### INFORMATION

Bevel gear wheels GN 297 are used for angular / T-gears in connection with linear actuators / transfer units GN 391 (see page 1940) and housings GN 298 (see page 1942).

The spiral bevel facilitates both setting the desired clearance and locating the correct position of the bevel gears. Also, gears set up this way run with extremely low noise levels.

Two bevel gears are needed for an angular gear, three bevel gears are needed for a T-gear. These are available as set in type W resp. type T. Please note that only bevel gears with different pitches can be paired. The transmission ratio is always 1:1, because the bevel gears always have the same number of teeth.

### TECHNICAL INFORMATION

- ISO-Fundamental Tolerances (see page A21)
- Assembly and application examples of Transfer units (see page 1944)

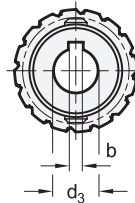

Type R

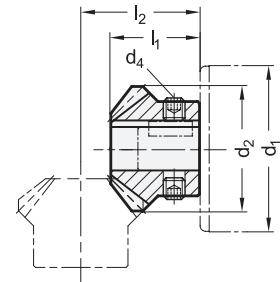

Type L



### GN 297

Description	d <sub>1</sub>	d <sub>2</sub>	d <sub>3</sub> H7 Bore	b	d <sub>4</sub>	l <sub>1</sub>	l <sub>2</sub>	σ
GN 297-14,5-K6-L	18	14.5	K 6	2	M 4	11	16	9
GN 297-25-K8-L	30	25	K 8	2	M 6	19	25	36
GN 297-33-K12-L	40 / 50	33	K 12	4	M 6	23.5	31	72
GN 297-40-K14-L	60	40	K 14	5	M 6	28	39	127
GN 297-14,5-K6-R	18	14.5	K 6	2	M 4	11	16	9
GN 297-25-K8-R	30	25	K 8	2	M 6	19	25	36
GN 297-33-K12-R	40 / 50	33	K 12	4	M 6	23.5	31	72
GN 297-40-K14-R	60	40	K 14	5	M 6	28	39	127
GN 297-14,5-K6-T	18	14.5	K 6	2	M 4	11	16	150
GN 297-25-K8-T	30	25	K 8	2	M 6	19	25	150
GN 297-33-K12-T	40 / 50	33	K 12	4	M 6	23.5	31	220
GN 297-40-K14-T	60	40	K 14	5	M 6	28	39	381
GN 297-14,5-K6-W	18	14.5	K 6	2	M 4	11	16	16
GN 297-25-K8-W	30	25	K 8	2	M 6	19	25	75
GN 297-33-K12-W	40 / 50	33	K 12	4	M 6	23.5	31	140
GN 297-40-K14-W	60	40	K 14	5	M 6	28	39	254